

# TECHNICAL DATASHEET



## REDUCED TEE 90°

03 Update - 06/2023

### TECHNICAL DATA

Article No	001 117 0042 0111
d1 (mm)	110
d2 (mm)	90
L (mm)	329
le1 (mm)	85
le2 (mm)	80
Z (mm)	160
s1 (mm)	10
s2 (mm)	8,2
Weight (Kg)	1,420
Box Quantity (pcs)	14
Box Dimension (pcs)	36x60x45

### IDENTIFICATION OF PRODUCT

D(mm)	110-90
SDR	11
RAW METARIAL	PE 100
PRESSURE CLASS	16 Bar Water 10 Bar Gas
TRADEMARK	NTG
EXECUTION	Injection Moulded
STANDARD	EN 12201-3 EN 1555-3 AS /NZS 4129

### INJECTION MOULDED

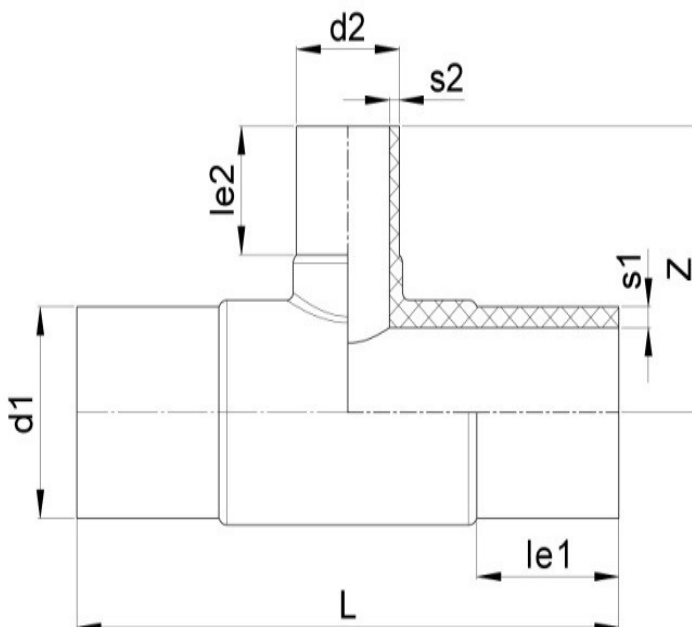

### SPECIFICATION

Long Spigot

Tolerance on diameters and thickness according to the standards. The other dimensions are specialized. Tolerance  $\pm 5\%$ . NTG PLASTIK reserves all the right to change any information without giving prior notice. The production, distribution and utilization of this document without explicit authorization is prohibited.